

WATS^{3D}®

GET STARTED

- Place testing components on a clean surface
- Activate handle several times to ensure it retracts and deploys properly

TESTING COMPONENTS

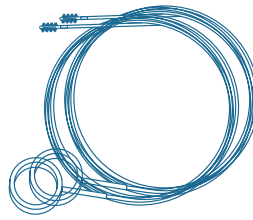

2 WATS^{3D} Brush Instruments

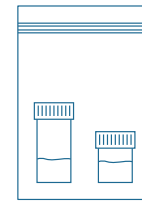

1 Tall and 1 Short Vial with Solution
Save Bag for Shipping

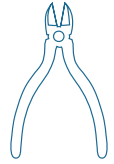

Wire Cutters
Required but not Included

BRUSH

1



Tall Vial

SAMPLE

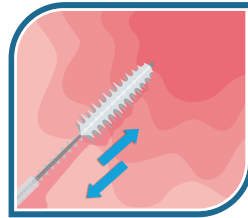

CLIP



- Advance the brush and place bristles against surface mucosa
- While maintaining firm pressure, repeatedly pass back and forth over the intended biopsy site
- With the tip of the brush slightly inserted into the tall vial, use cutters to clip off the bristle portion of the brush and submerge in the tall vial
- Replace cap and twist it closed, until the black line on the lid passes the black line on the vial

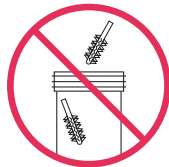

Do not place two brush tips into one vial. While not required, we recommend placing the first brush into the tall vial and the second brush into the short vial.

BRUSH

2



Short Vial

SAMPLE

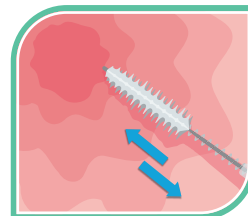

CLIP

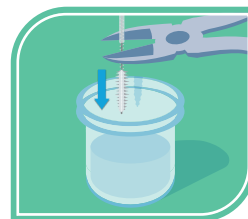

- Advance the brush and place bristles against surface mucosa
- While maintaining firm pressure, repeatedly pass back and forth over the intended biopsy site
- Clip off the bristle portion of the brush and submerge in the short vial
- Replace cap and twist it closed, until an audible click is heard

PACKAGE

Securely close both vials and seal in the bag

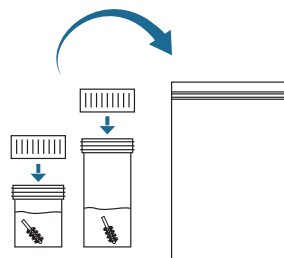

Pack the sealed bag and required paperwork and prepare to send to CDx Diagnostics®

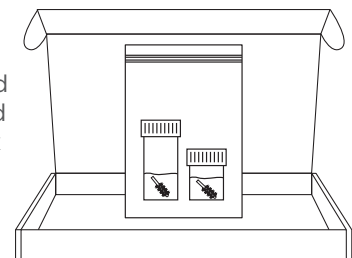

Watch Quick Reference Video

For any questions, or to schedule in-service training
Call 845-777-7000

This poster is provided as a quick reference guide to supplement in-service training provided by CDx Diagnostics.

©2021 CDx Diagnostics. All Rights Reserved GI_0110E 10.5.21

